

## Mini trunking

### Material

PVC-U is flame retardant and self-extinguishing. It is a 100% recyclable material.

Our PVC-U products are manufactured from an average of 80% recycled plastic, with some extruded products produced from 100% recycled material. The index at the back of the catalogue details the recycled content by individual product.

### Positioning

As feeder trunking.

## Cable capacities

- All calculations allow for a 45% space factor.
- Divide cable factor (1st table) into capacity (2nd table) to ascertain number of cables.

As there can be differences between data cable sizes, Marshall-Tufflex recommend that cable dimensions are confirmed with the manufacturing company.

Conductor type	Size	Cable factor
Stranded PVC power	1.5mm <sup>2</sup>	8.6
Stranded PVC power	2.5mm <sup>2</sup>	12.6
Stranded PVC power	4.0mm <sup>2</sup>	16.6
*Data cable	Ø5.5mm	23.8
*Data cable	Ø6.0mm	28.3
*Data cable	Ø6.5mm	33.2
*Data cable	Ø7.0mm	38.5
*Data cable	Ø8.4mm	55.4

Mini trunking	Size mm	45% capacity
MMT00	10 x 8	18.5mm <sup>2</sup>
MMT0	16 x 10	42mm <sup>2</sup>
MMT1	16 x 16	77.2mm <sup>2</sup>
MMT2	25 x 16	119.7mm <sup>2</sup>
MMT3	38 x 16	193mm <sup>2</sup>
MMT4	38 x 25	342mm <sup>2</sup>
MMT5	50 x 25	449mm <sup>2</sup>
MMT6	38 x 38	501mm <sup>2</sup>

### Maxi and Sceptre trunking

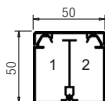

#### Maxi MTRS50

Total = 1979mm<sup>2</sup> total area  
 Total = 890mm<sup>2</sup> 45% space factor  
 1 & 2 = 911mm<sup>2</sup> total area  
 1 & 2 = 410mm<sup>2</sup> 45% space factor

#### Internal dimensions

Compartment 1 = 46 x 46mm

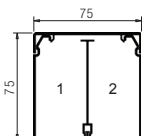

#### Maxi MTRS75

Total = 4709mm<sup>2</sup> total area  
 Total = 2119mm<sup>2</sup> 45% space factor  
 1 & 2 = 2196mm<sup>2</sup> total area  
 1 & 2 = 988mm<sup>2</sup> 45% space factor

#### Internal dimensions

Compartment 1 = 71 x 71mm

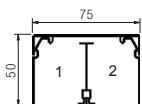

#### Maxi MTRS75/50

Total = 3032mm<sup>2</sup> total area  
 Total = 1365mm<sup>2</sup> 45% space factor  
 1 & 2 = 1347mm<sup>2</sup> total area  
 1 & 2 = 606mm<sup>2</sup> 45% space factor

#### Internal dimensions

Compartment 1 = 71 x 46mm

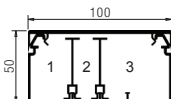

#### Maxi MTRS100/50

Total = 4040mm<sup>2</sup> total area  
 Total = 1818mm<sup>2</sup> 45% space factor  
 1 = 1056mm<sup>2</sup> total area  
 1 = 475mm<sup>2</sup> 45% space factor  
 2 = 660mm<sup>2</sup> total area  
 2 = 297mm<sup>2</sup> 45% space factor  
 3 = 1829mm<sup>2</sup> total area  
 3 = 823mm<sup>2</sup> 45% space factor

#### Internal dimensions

Compartment 1 = 94 x 46mm

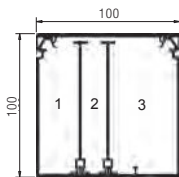

#### Maxi MTRS100

Total = 8733mm<sup>2</sup> total area  
 Total = 3930mm<sup>2</sup> 45% space factor  
 1 = 2375mm<sup>2</sup> total area  
 1 = 1069mm<sup>2</sup> 45% space factor  
 2 = 1464mm<sup>2</sup> total area  
 2 = 659mm<sup>2</sup> 45% space factor  
 3 = 4075mm<sup>2</sup> total area  
 3 = 1834mm<sup>2</sup> 45% space factor

#### Internal dimensions

Compartment 1 = 94 x 94mm

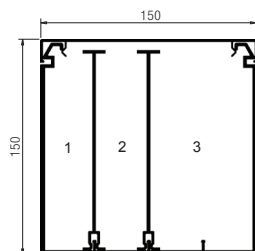

#### Maxi MTRS150

Total = 20193mm<sup>2</sup> total area  
 Total = 9087mm<sup>2</sup> 45% space factor  
 1 = 4406mm<sup>2</sup> total area  
 1 = 1983mm<sup>2</sup> 45% space factor  
 2 = 4728mm<sup>2</sup> total area  
 2 = 2128mm<sup>2</sup> 45% space factor  
 3 = 9482mm<sup>2</sup> total area  
 3 = 4267mm<sup>2</sup> 45% space factor

#### Internal dimensions

Compartment 1 = 143 x 144mm

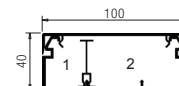

#### Sceptre DTR1

Total = 3168mm<sup>2</sup> total area  
 Total = 1426mm<sup>2</sup> 45% space factor  
 1 = 816mm<sup>2</sup> total area  
 1 = 367mm<sup>2</sup> 45% space factor  
 2 = 2002mm<sup>2</sup> total area  
 2 = 901mm<sup>2</sup> 45% space factor

Conductor type	Size	Cable factor
Stranded PVC power	1.5mm <sup>2</sup>	8.6
Stranded PVC power	2.5mm <sup>2</sup>	12.6
Stranded PVC power	4.0mm <sup>2</sup>	16.6
*Data cable	Ø5.5mm	23.8
*Data cable	Ø6.0mm	28.3
*Data cable	Ø6.5mm	33.2
*Data cable	Ø7.0mm	38.5
*Data cable	Ø8.4mm	55.4

For Data cable information, please see page 242

To determine cable capacity, select the size of the cable required and its corresponding cable factor from the table. Divide the compartment area figure (with or without 45% space factor) with the cable factor figure to achieve cable capacity.

**Note:** When 30mm deep accessory boxes are installed in MTRS100 and MTRS100/50, reduce the area by 2600mm<sup>2</sup>.

### Material

PVC-U is flame retardant and self-extinguishing. It is a 100% recyclable material.

### Positioning

Feeder or distribution trunking.



## Maxi and Sceptre trunking – continued

Maxi trunking Cable capacity chart	Total	Compartment 1	Compartment 2	Compartment 3
		With box	No box	With box
<b>PVC power cable 1.5mm<sup>2</sup> stranded copper</b>				
MTRS50	103	47	47	-
MTRS75	246	114	114	-
MTRS75/50	158	70	70	-
MTRS100/50	211	55	34	95
MTRS100	456	124	76	213
MTRS150	1056	230	247	496
<b>PVC power cable 2.5mm<sup>2</sup> stranded copper</b>				
MTRS50	70	32	32	-
MTRS75	168	78	78	-
MTRS75/50	108	48	48	-
MTRS100/50	144	37	23	65
MTRS100	311	84	52	145
MTRS150	721	157	168	338
<b>PVC power cable 4.0mm<sup>2</sup> stranded copper</b>				
MTRS50	53	24	24	-
MTRS75	127	59	59	-
MTRS75/50	82	36	36	-
MTRS100/50	109	28	17	49
MTRS100	236	64	39	110
MTRS150	547	119	128	257
<b>Data cable: Ø5.5mm</b>				
MTRS50	37	17	17	-
MTRS75	89	41	41	-
MTRS75/50	57	25	25	-
MTRS100/50	74	20	12	34
MTRS100	165	44	27	77
MTRS150	381	83	89	179
<b>Data cable: Ø6.0mm</b>				
MTRS50	31	14	14	-
MTRS75	74	34	34	-
MTRS75/50	48	21	21	-
MTRS100/50	64	16	10	29
MTRS100	138	37	23	64
MTRS150	321	70	75	150
<b>Data cable: Ø6.5mm</b>				
MTRS50	26	12	12	-
MTRS75	63	19	29	-
MTRS75/50	41	18	18	-
MTRS100/50	54	14	8	24
MTRS100	118	32	19	55
MTRS150	273	59	64	128
<b>Data cable: Ø7.0mm</b>				
MTRS50	23	10	10	-
MTRS75	55	25	25	-
MTRS75/50	35	15	15	-
MTRS100/50	47	12	7	21
MTRS100	102	27	17	47
MTRS150	236	51	55	110
<b>Data cable: Ø8.4mm</b>				
MTRS50	16	7	7	-
MTRS75	38	17	17	-
MTRS75/50	24	10	10	-
MTRS100/50	32	8	5	14
MTRS100	70	19	11	33
MTRS150	164	35	38	76

## Cable capacities

- All calculations allow for a 45% space factor.

As there can be differences between data cable sizes, Marshall-Tufflex recommend that cable dimensions are confirmed with the manufacturing company.

Sceptre trunking Cable capacity chart	Total	Compartment 1	Compartment 2
		No box	No box
<b>PVC power cable 1.5mm<sup>2</sup> stranded copper</b>			
DTR1	165	42	104
<b>PVC power cable 2.5mm<sup>2</sup> stranded copper</b>			
DTR1	113	29	71
<b>PVC power cable 4.0mm<sup>2</sup> stranded copper</b>			
DTR1	85	22	54
<b>Data cable: Ø5.5mm</b>			
DTR1	59	15	37
<b>Data cable: Ø6.0mm</b>			
DTR1	50	12	31
<b>Data cable: Ø6.5mm</b>			
DTR1	42	11	27
<b>Data cable: Ø7.0mm</b>			
DTR1	37	9	23
<b>Data cable: Ø8.4mm</b>			
DTR1	25	6	16

### Cornice trunking

#### Material

PVC-U is flame retardant and self-extinguishing. It is a 100% recyclable material.

Our PVC-U products are manufactured from an average of 80% recycled plastic, with some extruded products produced from 100% recycled material. The index at the back of the catalogue details the recycled content by individual product.

#### Positioning

For surface wiring around ceilings.

#### Dimensions

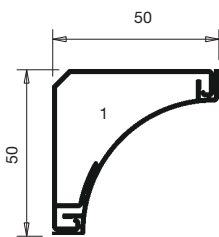

1 = 873mm<sup>2</sup> total area  
 1 = 393mm<sup>2</sup> 45% space factor

### Cable capacities

- All calculations allow for a 45% space factor.

As there can be differences between data cable sizes, Marshall-Tufflex recommend that cable dimensions are confirmed with the manufacturing company.

Cable capacity chart	Cable factor	Compartment 1
PVC power cable 1.5mm <sup>2</sup> stranded copper	8.6	45
PVC power cable 2.5mm <sup>2</sup> stranded copper	12.6	31
PVC power cable 4.0mm <sup>2</sup> stranded copper	16.6	23
Data cable: Ø5.5mm	23.8	16
Data cable: Ø6.0mm	28.3	13
Data cable: Ø6.5mm	33.2	11
Data cable: Ø7.0mm	38.5	10
Data cable: Ø8.4mm	55.4	7

## Sovereign Plus trunking

### Material

PVC-U is flame retardant and self-extinguishing. It is a 100% recyclable material.

Our PVC-U products are manufactured from an average of 80% recycled plastic, with some extruded products produced from 100% recycled material. The index at the back of the catalogue details the recycled content by individual product.

### Positioning

Suitable for skirting and architrave. If used for skirting applications, a clearance of 10mm is recommended above the floor covering to maintain IP4X rating.

### Bend radius control

Not available.

### Screening

Not available.

## Dimensions

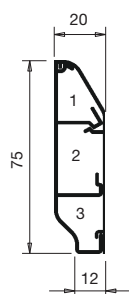

### Sovereign Plus skirting

- 1 = 238mm<sup>2</sup> total area
- 1 = 107mm<sup>2</sup> 45% space factor
- 2 = 416mm<sup>2</sup> total area
- 2 = 187mm<sup>2</sup> 45% space factor
- 3 = 261mm<sup>2</sup> total area
- 3 = 117mm<sup>2</sup> 45% space factor

### Cable capacities

- All calculations allow for a 45% space factor.

As there can be differences between data cable sizes, Marshall-Tufflex recommend that cable dimensions are confirmed with the manufacturing company.

Cable capacity chart	Compartment 1	Compartment 2	Compartment 3
<b>PVC power cable 1.5mm<sup>2</sup> stranded copper</b>			
Sovereign Plus	12	21	13
<b>PVC power cable 2.5mm<sup>2</sup> stranded copper</b>			
Sovereign Plus	8	14	9
<b>PVC power cable 4.0mm<sup>2</sup> stranded copper</b>			
Sovereign Plus	6	11	7
<b>Data cable: Ø5.5mm</b>			
Sovereign Plus	4	7	4
<b>Data cable: Ø6.0mm</b>			
Sovereign Plus	3	6	4
<b>Data cable: Ø6.5mm</b>			
Sovereign Plus	3	5	3
<b>Data cable: Ø7.0mm</b>			
Sovereign Plus	2	4	3
<b>Data cable: Ø8.4mm</b>			
Sovereign Plus	1	3	2

## Bench trunking

### Material

PVC-U is flame retardant and self-extinguishing. It is a 100% recyclable material.

Our PVC-U products are manufactured from an average of 80% recycled plastic, with some extruded products produced from 100% recycled material. The index at the back of the catalogue details the recycled content by individual product.

### Positioning

If used for skirting applications, a clearance of 10mm is recommended above the floor covering to maintain IP4X rating.

Bench and desk installations: a single run can be fitted to rear of furniture or, if run down centre line, two units can be joined back to back presenting accessories on both sides.

### Antimicrobial

For technical details of antimicrobial Bio Bench trunking, please refer to Laboratory and Healthcare section on page 293.

### Dimensions

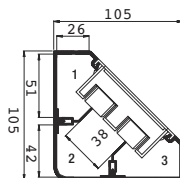

#### Bench trunking – with box

- 1 = 1285mm<sup>2</sup> total area
- 1 = 578mm<sup>2</sup> 45% space factor
- 2 = 2128mm<sup>2</sup> total area
- 2 = 957mm<sup>2</sup> 45% space factor
- 3 = 1285mm<sup>2</sup> total area
- 3 = 578mm<sup>2</sup> 45% space factor

#### Bench trunking – no box

- 1 = 1782mm<sup>2</sup> total area
- 1 = 802mm<sup>2</sup> 45% space factor
- 2 = 3282mm<sup>2</sup> total area
- 2 = 1477mm<sup>2</sup> 45% space factor
- 3 = 1782mm<sup>2</sup> total area
- 3 = 802mm<sup>2</sup> 45% space factor

### Cable capacities

- All calculations allow for a 45% space factor.

As there can be differences between data cable sizes, Marshall-Tufflex recommend that cable dimensions are confirmed with the manufacturing company.

Cable capacity chart	Compartment 1		Compartment 2		Compartment 3	
	No box	With box	No box	With box	No box	With box
PVC power cable 1.5mm <sup>2</sup> stranded copper	93	67	171	111	93	67
PVC power cable 2.5mm <sup>2</sup> stranded copper	63	45	117	76	63	45
PVC power cable 4.0mm <sup>2</sup> stranded copper	48	34	88	57	48	34
Data cable: Ø5.5mm	33	24	62	40	33	24
Data cable: Ø6.0mm	28	20	52	33	28	20
*Data cable: Ø6.5mm	24	17	44	28	24	17
*Data cable: Ø7.0mm	20	15	38	24	20	15
*Data cable: Ø8.4mm	14	10	26	17	14	10

\*Only for straight runs. If bends are required please contact the Technical Team on +44 (0)1424 856688.

