

Grommets

Material

- ABS Flame retardant
- Flammability: UL94 V-0 at 2.0mm
- Colour: polypropylene grey RAL 7011
- Lid: captive screwdown
- Lid recess: 15mm for extra strength
- Through power/data options

Dimensions

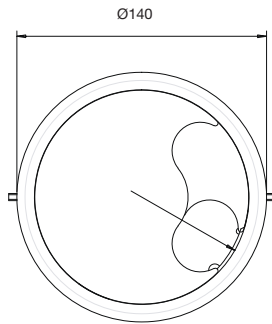

Cut out dimensions

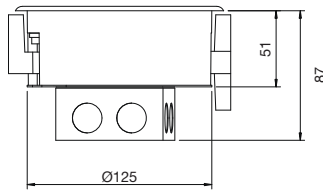

In-screed system

Three and four compartment boxes configured to meet client requirements for accessing multiple services concealed within an in-screed floor system.

Standard system is suitable for screed depths of 65mm to 85mm. For other screed depths please contact our Technical Team on +44 (0)1424 856688.

Material

- Lid/trim: polypropylene grey RAL 7011
- Frame assembly: galvanised steel
- Modular boxes: galvanised steel
- Load plate: galvanised steel

Wiring accessories and mounting plates

- 3 compartment box: 185 x 95mm
- 4 compartment box: 185 x 71mm
- For use with standard 60.3mm and 120.6mm accessories with blank or pre-punched plates for data/telecoms etc.

Junction box

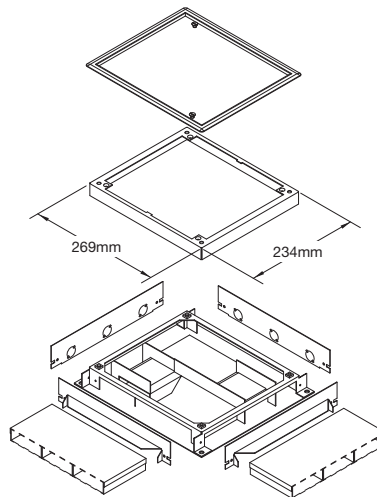

Desk grommets

Dimensions

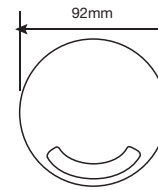

Cut out size

Box type	Diameter
DG1	80mm
General tolerance	2mm

Floor outlet box

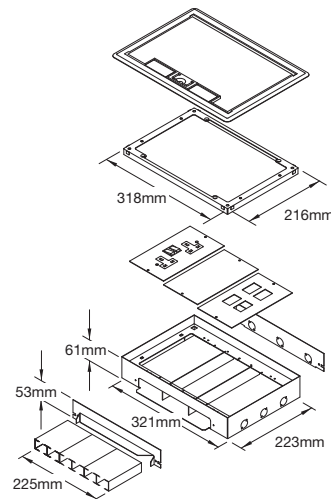

Box screed depth adjustment

