

# MARSHALL-TUFFLEX

## Aluminium Sterling Curve Skirting Trunking



UK OWNED  
UK MANUFACTURER



### INSTALLATION INSTRUCTIONS

#### PLANNING INSTALLATION

Establish layout, paying attention to; direction of changes, Feed position & Component spacing.

#### CLEANING

The exterior should be cleaned using a damp cloth.

#### DISPOSAL

The product and packaging should be disposed of via standard civic amenity facilities.

In accordance with current IET wiring regulations BS 7671, assembly and connection is to be carried out by a qualified electrician or other competent person. In addition, when installing electrical products, personal protective equipment must meet the current version of the Personal Protective Equipment at Work Regulations.

For product classification refer to DOC03758, 1 and 2 Gang Frames conform to the requirements of BS 4662 where applicable. If you are in any doubt regarding the installation or application of the product, please contact:  
The Technical Team on +44 (0) 1424 856688.

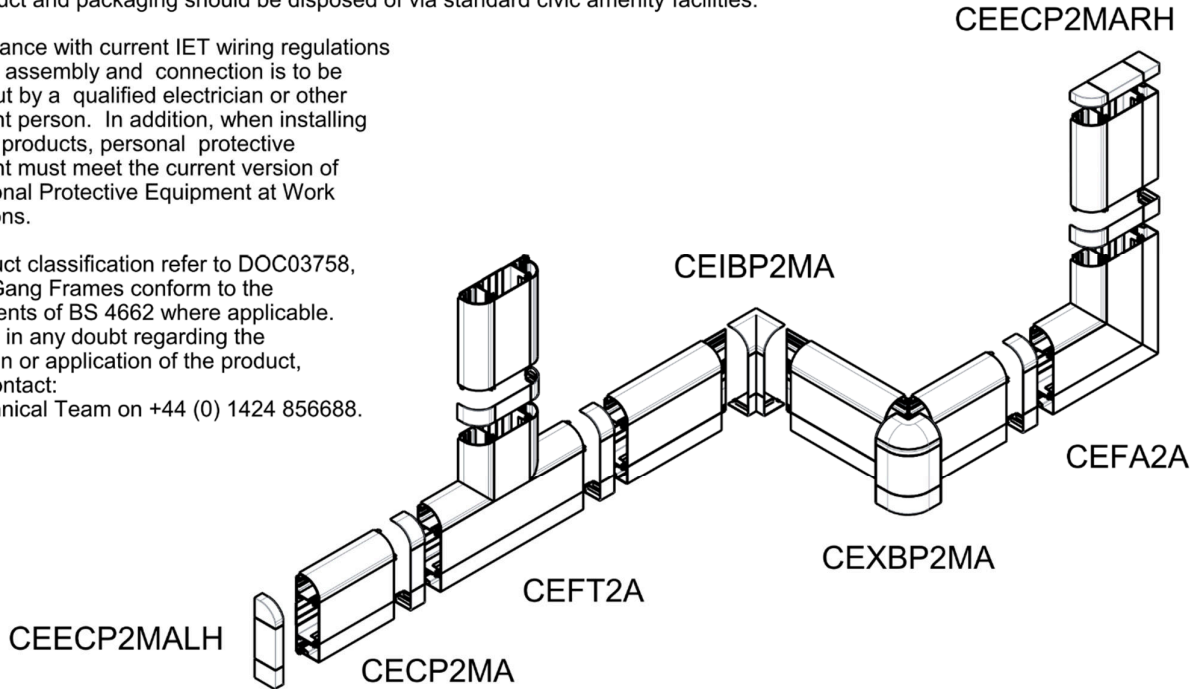

#### [1] When fitting trunking be mindful of

When used as a skirting system or run against a vertical wall, sufficient clearance must be allowed for between floor covering or wall and the profile fittings that clip over the covers (End Cap, Coupler, Flat Angle and Flat Tee)

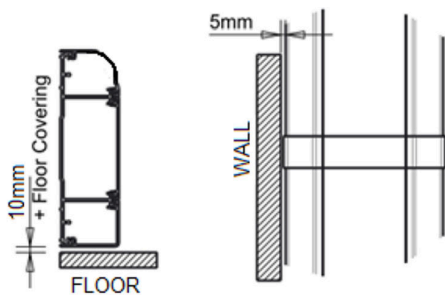

#### [2] Base and Covers

To fasten the base use No.8 round head screws & washers, Use of plastic caps over screw heads is recommended to protect cables.

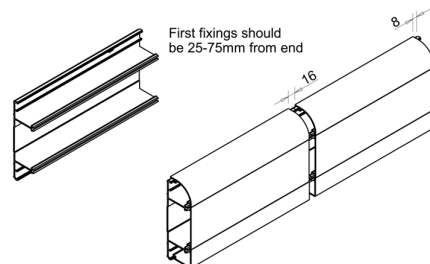

Base to base and Lid to Base bonding on all sections of trunking is recommended to maintain continuity – when fitting fabricated fittings bonding from trunking base to fabrication base is also recommended.

### [3] Retention of Fittings

All fittings clip into the trunking base with exception of the End Caps. No additional fastening device is necessary. All are provided with a generous 10mm overlap at joints, to accommodate thermal expansion and to compensate for errors in cutting.

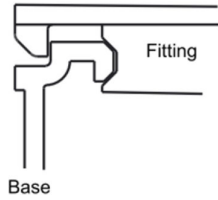

### [4] Secured End Cap

End Caps butt up to the end of the base. Fixing screws are required for retention of end cap to meet classification. No.8 screws are recommended.

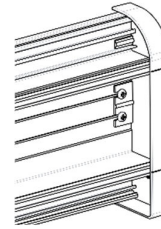

### [5] Internal & External Bends

Base can be mitred 45° to ensure total enclosure of cables or for external bend base can be cut square to wall.



Allow 3mm gap for thermal expansion.

### [6] Internal Bends

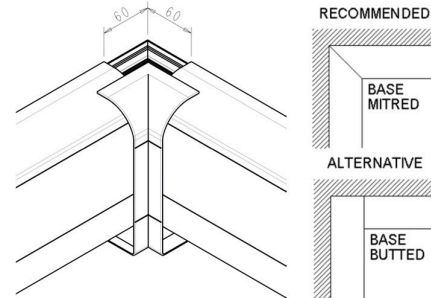

After fixing base to corner, fit covers with offset as shown then clip internal bend in place.

### [7] External Bends

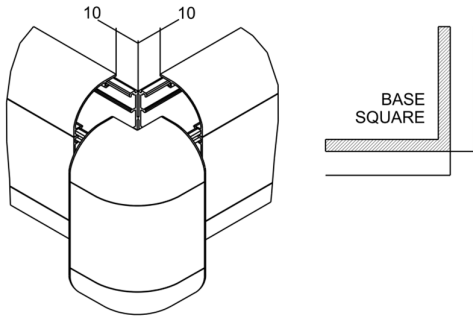

After fixing base to corner, fit covers with offset as shown then clip external bend in place.

### [8] Offset Dimensions

The minimum set that can be accommodated in the same plane (from internal to external bed)

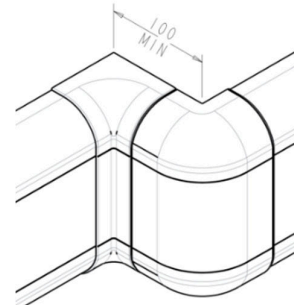

### [9] Cover removal

The lids have been designed to remain in position irrespective of impact during normal conditions and minor undulations of the fixing surface. Lids are designed to limit their unauthorised removal. All lids peel off, although curved and square lids can be eased from the base by inserting a screwdriver between the captive legs of the lid and base. The lids can then be peeled from the base.

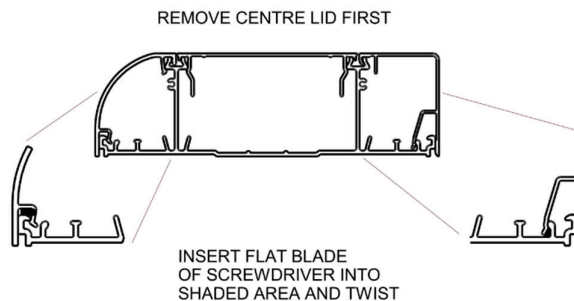

### [10] Method of Continuation Through a Partition Wall

Continue the main lateral run of base through the partition with short lengths of cover fitted where the trunking passes through the partition. The partition wall trunking is then butted up to the main run and the joint covered by an internal bend.

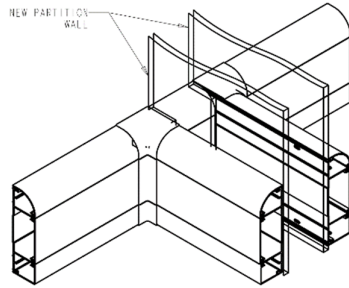

### [11] Short Length

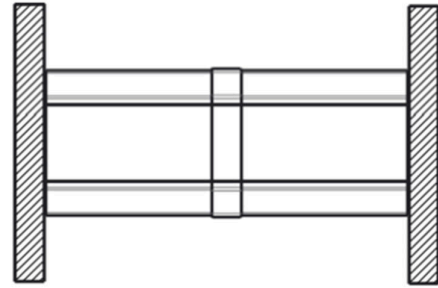

To fit a single length of trunking (under 3 metres) between two inside walls and with no accessory box fitted; it is advisable to install a coupler in the centre of the run to faceplate the removal of the cover.

### [12] Flat Angle and Flat Tee

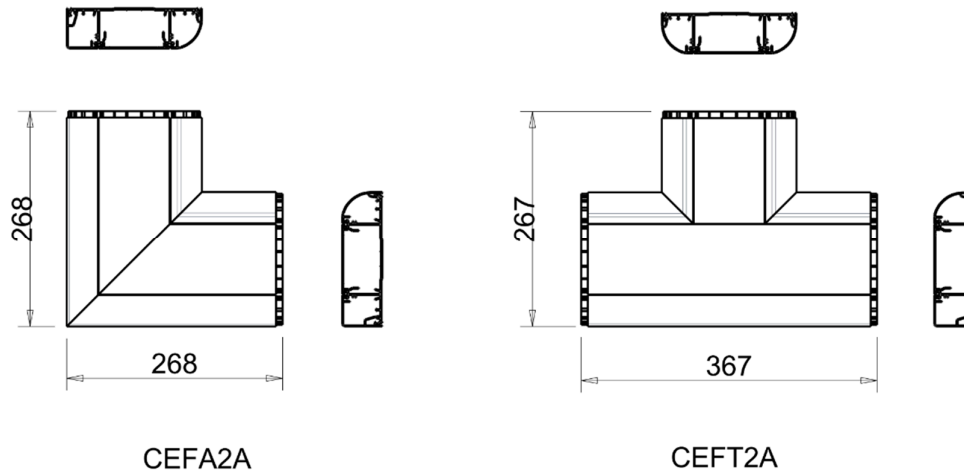

CEFA2A

CEFT2A

Flat Angle and Flat Tee to be assembled as shown in illustration, Fabrications have covers recessed 8mm to allow fitment of coupler with 10mm overlap. 2 couplers needed for Flat Angle and 3 couplers needed for Flat Tee – Please note the middle section of the Tee is constructed with 2 off curved outer covers (Dado configuration) and will need 1 coupler to be Dado type CECP1MA.

### [13] Mini Trunking and Round Conduit Adaptor

Fitting of universal adaptor for MMT2 and MMT4 Mini Trunking or 20 and 25mm Round Conduit.

LEAVE GAP OF 60mm BETWEEN OUTER COVERS FOR FITTING OF ADAPTOR

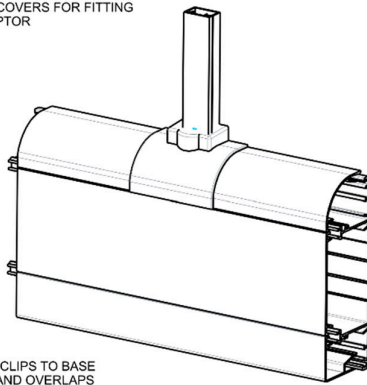

ADAPTOR CLIPS TO BASE SECTION AND OVERLAPS OUTER COVER BY 10mm EITHER SIDE

DRILL THROUGH USING MARKS ON TOP SURFACE AS GUIDE, 20mm OR 25mm DIAMETER

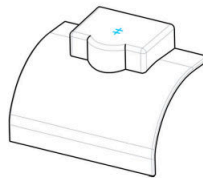

CUT OUT USING GUIDE LINES TO SUIT MMT2 OR MMT4 MINI TRUNKING

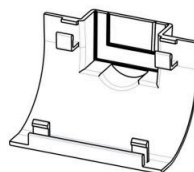

Note: conduit sits 4.5mm off wall when mounted with saddle straps, guide marks for 20mm is closest to open face of adaptor (14.5mm)

