

TRIPLE STAR FIRE & SECURITY ENHANCES EFFICIENCY WITH TUFFLEX TILE

Fire system specialist Triple Star Fire & Security is streamlining its fire detection and alarm system installations with the lightweight pattress solution - Tufflex Tile.

Kent-based Triple Star Fire & Security supplies, installs and maintains life safety equipment, including fire alarms and detection systems for a diverse range of properties ranging from the iconic Royal Liver Building in Liverpool and Goldsmiths University of London to care homes and prestigious London mansions. The family-owned business is committed to quality, innovation and improving standards within the industry.



Managing Director Daren Pool wanted to find a way to streamline the installation of fire detection and alarm systems in suspended ceilings as part of the company's drive to deliver a high level of service. Traditional methods involving a plywood or MDF pattress are time-consuming and cumbersome, so a more efficient method was needed.

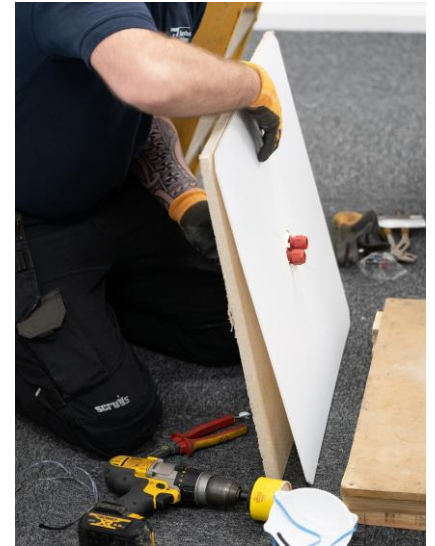

Tufflex Tile from Marshall-Tufflex, which Triple Star Fire & Security purchase from electrical wholesaler, Rexel in Maidstone, has provided the perfect solution. The tile is manufactured from Correx, making it extremely lightweight yet robust. Significantly, Tufflex Tile is pre-cut to the standard 595mm² ceiling tile aperture which reduces cutting and saving time on site so pattress installations can be carried out quickly and trouble-free. In addition, as Correx is flame retardant and (LSF) low smoke fume, it removes a vital component of the fire triangle, significantly benefiting the end user. "It's a great product, especially with the tapered corners that help make installation far easier as we no longer need to spend time shifting and negotiating the pattress into the ceiling suspension system," says Daren. "It also allows us to work with a fire-rated material, compared to the traditional plywood or MDF pattress."



Triple Star Fire & Security has already used Tufflex Tile on eight fire detection and alarm system projects that feature a mix of wired and wireless devices. "Tufflex Tile delivers a significant time saving for our installations and also overcomes us having to ask the main contractor to provide wooden pattresses," concludes Daren Poole.

By adopting Tufflex Tile, Triple Star Fire & Security has enhanced its efficiency without compromising on quality and demonstrates how, by choosing effective materials, Marshall-Tufflex delivers reliable and effective solutions.

To find out more, visit www.marshall-tufflex.com/tufflextile